



CHIPPEWA VALLEY RAILROAD ASSOCIATION NEWSLETTER SEPTEMBER 2019

Next Meeting - 6:45 PM - Tuesday , September 17, 2019

Chippewa Valley Railroad Depot, Eau Claire, WI
Carson Park, Eau Claire, WI

August and Labor Day Weekend Update Highlights: August weather finally settled down to normal with pleasant weather which upped our ridership closer to normal around 400 to 500 riders. We ended the season within our average for past few years.

LABOR DAY OPERATION

No. 19 and No. 16 double headed for the day with 5 coaches. Most trains were full. Thanks to Kirk Olson, Marc Brown, Dave Peterson, Frank Garber, Heather Garber, Andy Stanton, Max Koehn, Eathan, and Bob Anderson, we had a busy day.

We also had a visitor, Dave George, from the Lake Superior Railroad Museum. Dave works on the Duluth & Northeastern 28, a 2-8-0 steam locomotive. He took a few runs on No 16, the second engine of the double header.



West Branch Work. This coming Monday and Tuesday, September 9th and 10th, we will have the Chippewa Corrections Crews back in town to help with the completion of the West Side Branch. We need all the supervision we can muster.

The objectives are:

1. Connecting the new track to the outer passing track on the west side of the loop.
2. Fabricate additional panel track sections to complete the connection of the inner passing track to existing mainline.
3. Begin ballasting the West Branch Line.
4. Begin leveling of sections of the track.
5. Clean the roundhouse and remove items to be scraped.

SEPTEMBER MEETING DATE CHANGE

We will change the date of the September meeting from the 10th to the 17th since we will be working on the 10th. After two days of working, we decided the addition time for a meeting on the 10th is a bit too much.

Please make a note of the change.

The August meeting minutes and financials will be sent prior to the meeting.

CHIPPEWA VALLEY RAILROAD ASSOCIATION

West Side Branch.
New line.

Photo Next Page
Taken here

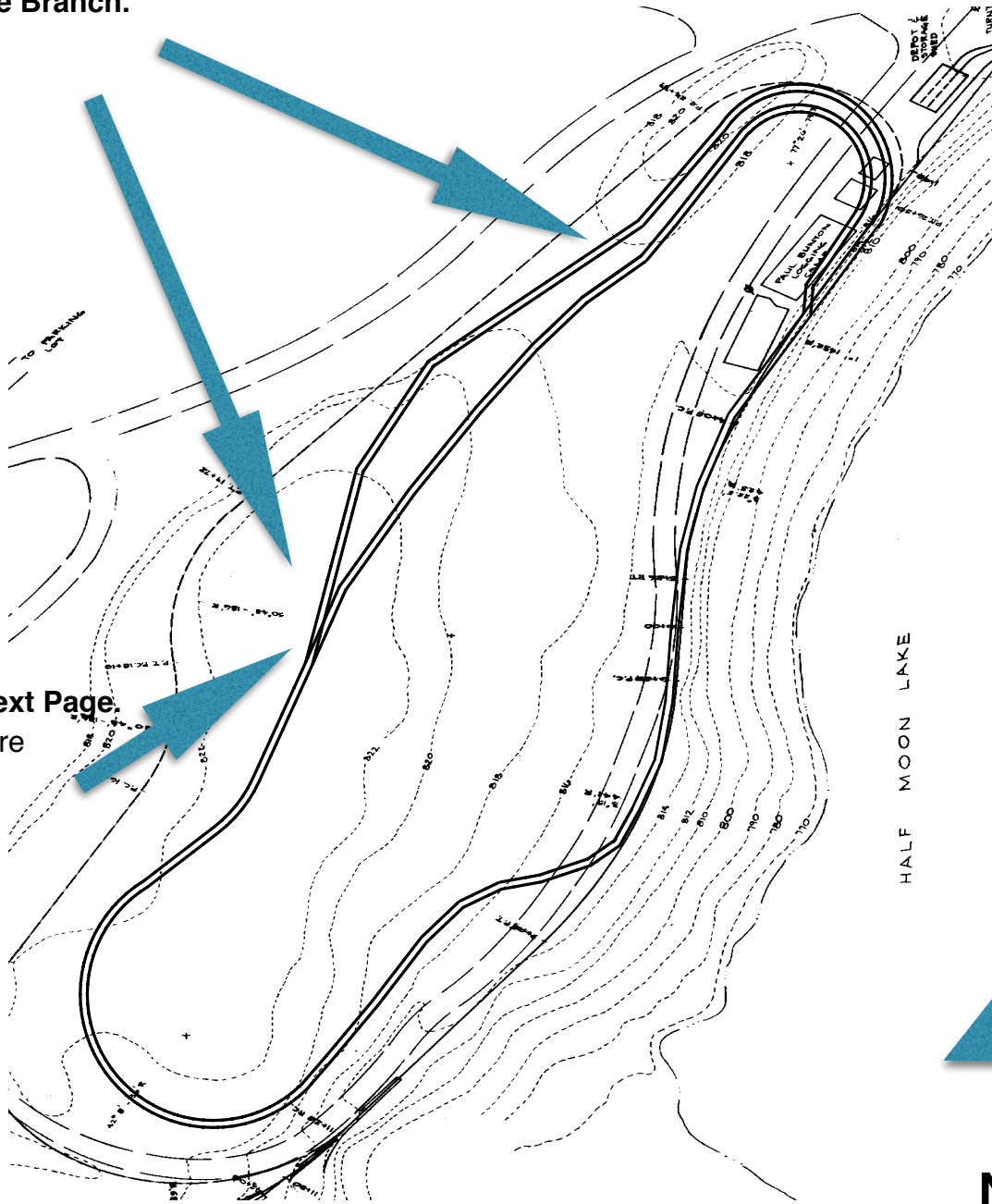

1

TRACK PLAN

SCALE: 1" = 100'

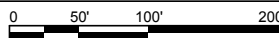

Track Plan The track plan will look this next season. We did not connect the West Side Branch since we did not want to risk any issues that might interrupt operation at the end of the season. We will begin the connections September 9th and 10th.